

DISEÑADORES	FRMA
ARQUITECTA:	KARLA MADROR MORA
ESTRUCTURA:	ALDO WALTERS FERREZOLITRANA
ELECTRICO:	UISSES MARTINEZ R.
HIDRO-SANITARIO:	ORLANDO BERNARDEZ
INFORMÁTICA:	CARMEN D. MARTINEZ
DEBULO:	YAOSKA MEZA M.
COORDINADOR:	LUIS JAVIER MEZA

NOMBRE	FRMA	FECHA
REVISIONES		

ESPECIALIDAD:
 INFORMATICA

CONTENIDO:
 PLANTA DE DISTRIBUCION DE PUNTOS DE RED EDIFICIO 1 ADMINISTRACION

ESCALA:	INDICADA
LÁMINA:	IN-01 DE: IN-02
CONSEJUTIVO:	111 de 112
	ABRIL 2011

NEWLINK Cabling Systems **NEW-0934015**

30" x 21 1/2" x 23 1/2" Wall Mount Cabinet

Newlink offers a unique all steel enclosure that is both strong and attractive. Our design allows us to maintain tighter tolerances for our products and provides more secure attachment to your computer room.

Features:

- Dimensions: 30" x 21 1/2" x 23 1/2"
- Heavy Duty Steel
- Front Glass Door w/Locks
- Side Panels
- Side Paneling Device
- ISUR

Related Products



NEW-0924019	24" (12 RMU) - wallmount cabinet, glass door
NEW-0951022	35" (27 RMU) - wallmount cabinet, glass door
NEW-0919042	78" (42 RMU) - standone cabinet, glass door
NEW-0191510	12" depth ventilated steel shelf
NEW-0191511	12" depth solid steel shelf
NEW-0191512	14" depth ventilated steel shelf
NEW-0191513	14" depth solid steel shelf

Ordering Information

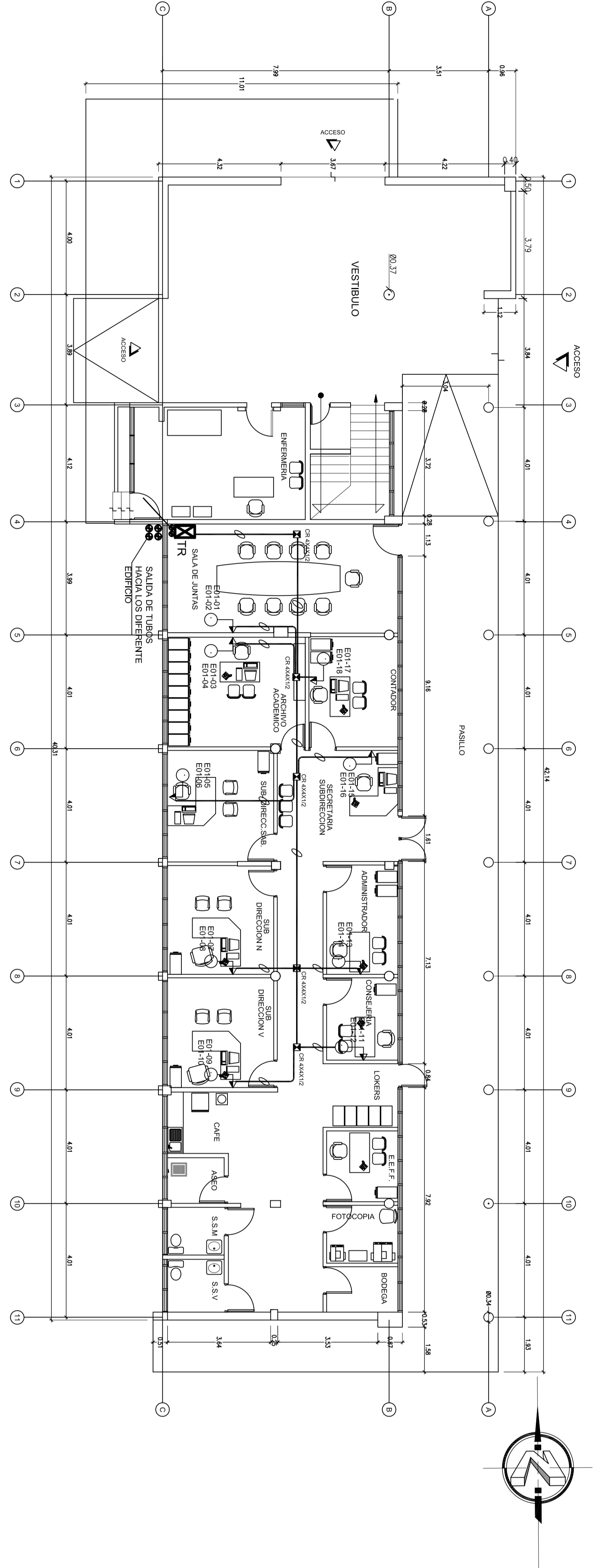
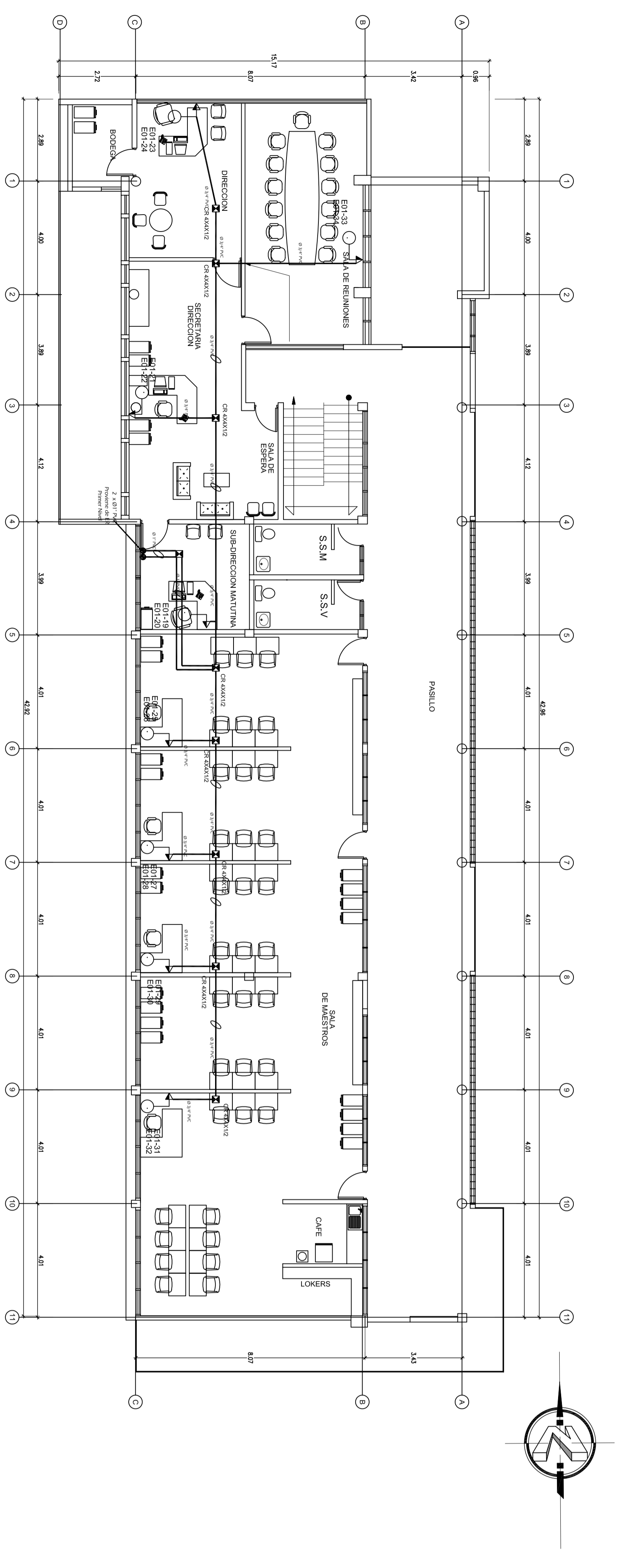
- NEW-0934015 30" (15 RMU) - Wallmount Cabinet, w/front glass door w/lock, ventilated steel door w/lock, heavy duty side panels, fan cooling device

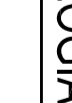
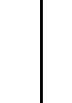
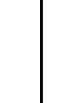

SIMBOLOGIA

	ER01 CUARTO DE EQUIPOS.
	TR01 CUARTO DE TELECOMUNICACIONES.
	PERFORACION EN LOS BAUNTES
	SAIDA DE DATOS EN PARED O MUEBLE. COMPUESTA POR: PLACA CON VENTANA DE 1-PUERTOS, JACK R445 CATEGORIA 5E, COLOR AZUL, NO PARTE. 50108-41LS MARCA LEVITON.
	CAJA DE REGISTRO
	TUBERIA DE PVC EMPOTRADA DADOLEDO A DIAMETRO INDICADO